



MONCRIEFF[®] businessCENTER

14603 East Moncrieff Place
Aurora, CO 80011

101,406 Sq. Ft.

Office / Warehouse

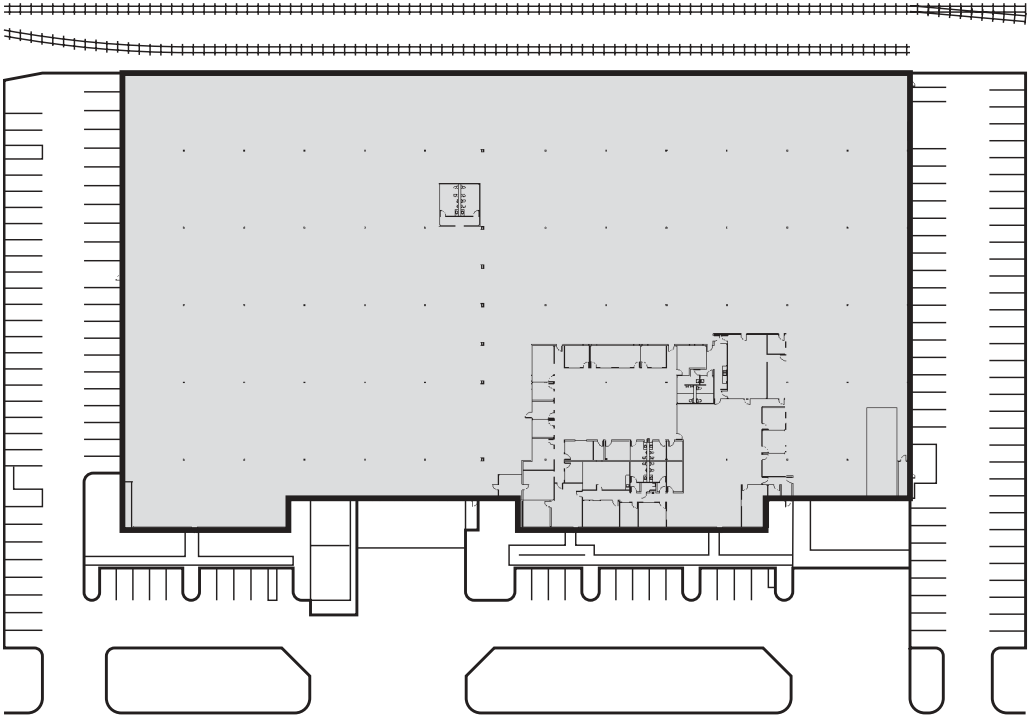

EAST MONCRIEFF PLACE

Key Features:

- Great location - near DIA and Downtown Denver
- Excellent Ingress & Egress to I-70 and I-225
- Rapidly expanding employment & residential population base
- Pre-fab concrete building
- 24' high ceilings
- Light industrial zoning
- Entire building sprinklered ESFR is available
- Doors: 9 dock high doors (including 1 interior) 2 drive-in doors; 1 ramped drive-in; and 6 rail doors
- Ample parking
- Local ownership
- Responsive, professional management



Click on map for directions, more views and area amenities.