



SINCE 1869

CHURCH RANCH
CORPORATE CENTER

**10249 Church Ranch Way
Westminster, CO 80021**

63,057 Sq. Ft.

Office / Flex

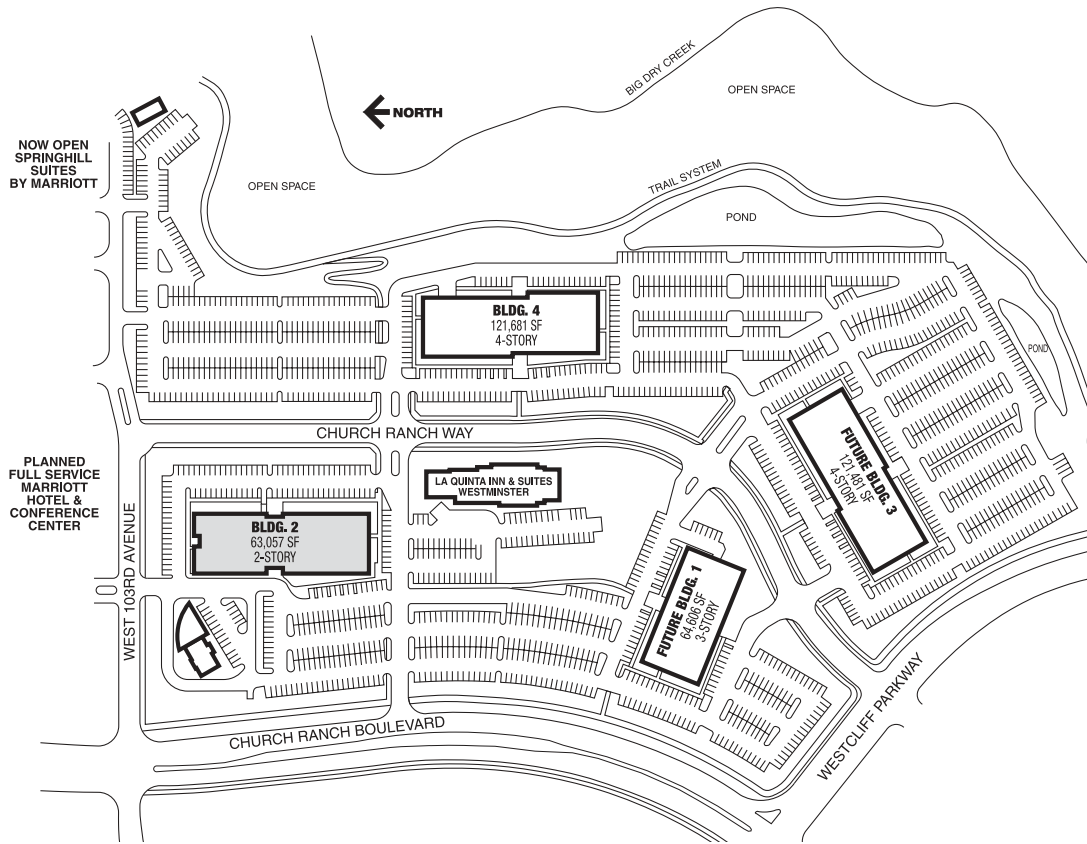

Key Features:

- Multi-story office space featuring flexible floor plans
- Outstanding accessibility and visibility from US-36
- Fiber-optic capabilities for advanced computing, teleconferencing and videoconferencing
- On-site childcare center, banking and hotels
- Adjacent open space
- Excellent proximity to gas station and convenience store
- All buildings interconnected by Communication Railway
- Mountain views, adjacent creeks and trail systems
- Beautifully landscaped with water features
- Adjacent to single-family homes and Eagle's Landing Apartments
- Located 12 minutes from Boulder and 15 minutes from downtown Denver
- Located on RTD route
- Local ownership
- Responsive, professional management



**ETKIN
JOHNSON**
GROUP

BARBARA MYERS

303.223.0496 phone
303.629.5451 fax
BMyers@etkinjohnson.com
etkinjohnson.com